

Jetstream Foam 850

The Jetstream Foam Units are portable chemical foam generators designed to apply a large range of foaming chemicals to surfaces where the chemical is required to be in contact for prolonged periods. Only requiring a compressed air supply to be fully operational, all units are self contained and totally mobile. Adjustment of the air control on the trolley enables the consistency of the foam to be varied to suit the particular application.

The Jetstream consists of a 50-litre stainless steel tank with an integral trolley and all stainless steel wetted parts. The mobility of the unit is enhanced by using either nylon or rubber 8" wheels.

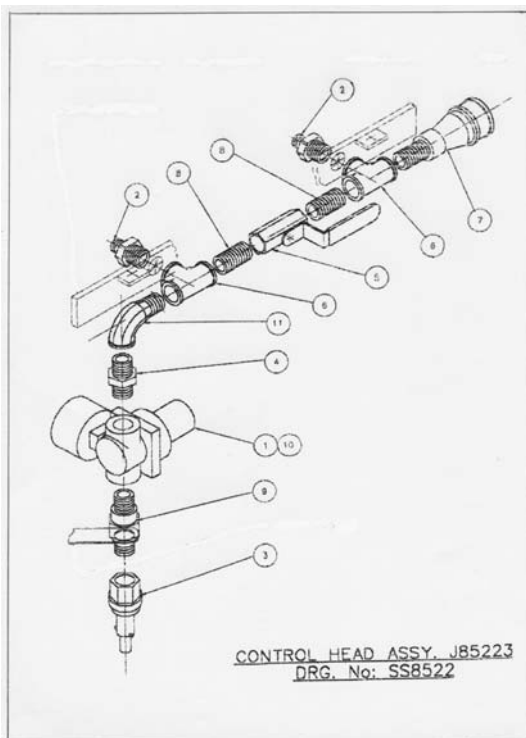

Advantages of Foam

Contact time maximises chemicals effectiveness

Visual marker for operator

Expansion rates reduce water and chemical usage

Reduced labour costs

Features:

- 50 litre stainless steel tank
- Quick Release 1/4" compressed air connection
- Simple operation between 40-85 psi
- 5mtr foam hose with stainless steel ball valve & 1m foam lance
- 2 Stainless steel nozzles (1 rope jet & 1 fan jet)



Certificate No: Q.11704



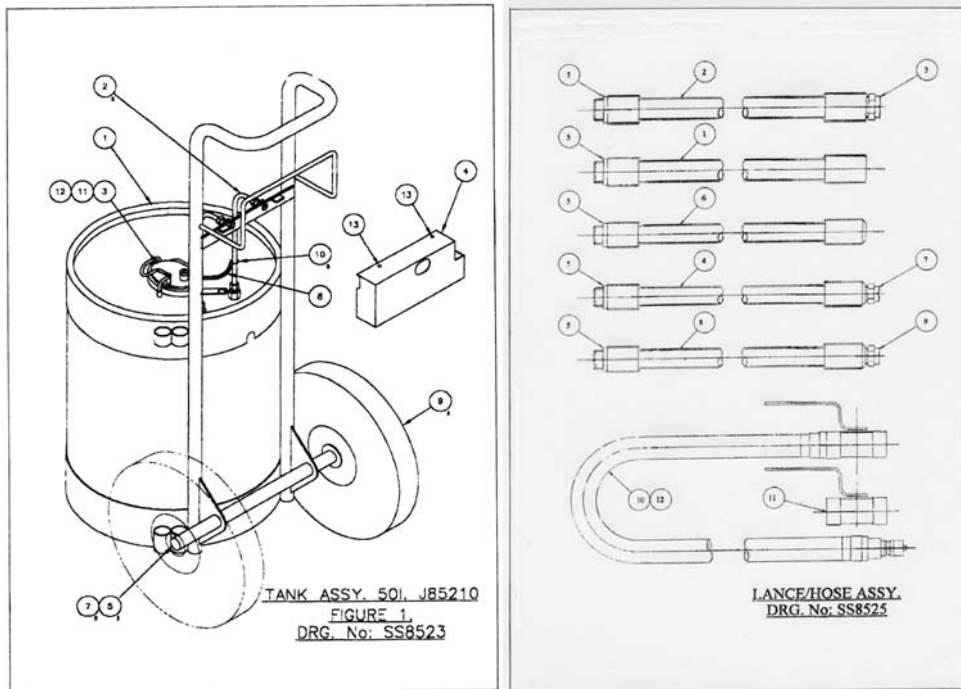

Applications:

Cleaning

Trucks, buses, trains, aircraft, military etc.

Cleaning/Sanitising

Food processing plants, breweries, dairies, slaughter houses, showers, toilets, industrial, agricultural etc.

Technical Specification:

A stainless steel cylinder of 384mm internal diameter and 324mm length, with a 600mm radii domed end shell welded onto each end, giving an overall tank length of 450mm. In addition, circular rolled 'chimbs' are welded onto each end, making an overall container length of 535mm

Tanks are made from 316 grade stainless steel and chimbs from 304 grade stainless steel. All material is 1.5mm thick.

Construction is fully welded, using the TIG process.



Certificate No: Q.11704





The Merlin Centre, Gatehouse Close,
Aylesbury, Bucks. HP19 8DP

Telephone: 01296 393822

Facsimile: 01296 399757

Email: spraysys@btconnect.com

Each container is fitted with two male threaded connectors, which are welded in from the inside, and an elliptical service aperture. All are located in the top dome end.

Stainless steel labels are welded onto the chimbs, which are stamped with the relevant data for compliance with the pressure systems regulations, each container carrying a unique serial number.

Following manufacture, each container is subjected to a 'maximum working pressure' air pressure test, following which it is fitted with a short filler pipe and a long pick-up pipe, both of which are retained by 'Viton 'O' rings', special sealant and stainless hexagon retaining nuts.

Following final manufacture and assembly of the JETSTREAM unit at Spray Systems, the whole unit is subjected to a static pressure test at 140psi and an operating mode test for the relief valve at 80psi.



Certificate No: Q.11704

